

## Einfachwirkende Hydraulikzylinder 210 bar

### Baureihe: HZE1 // Bauform: A

#### Einfachwirkende Hydraulikzylinder 210 bar Baureihe: HZE1 Bauform: A

Lage der Entlüftungen P7 und des Anschlussstutzen P8

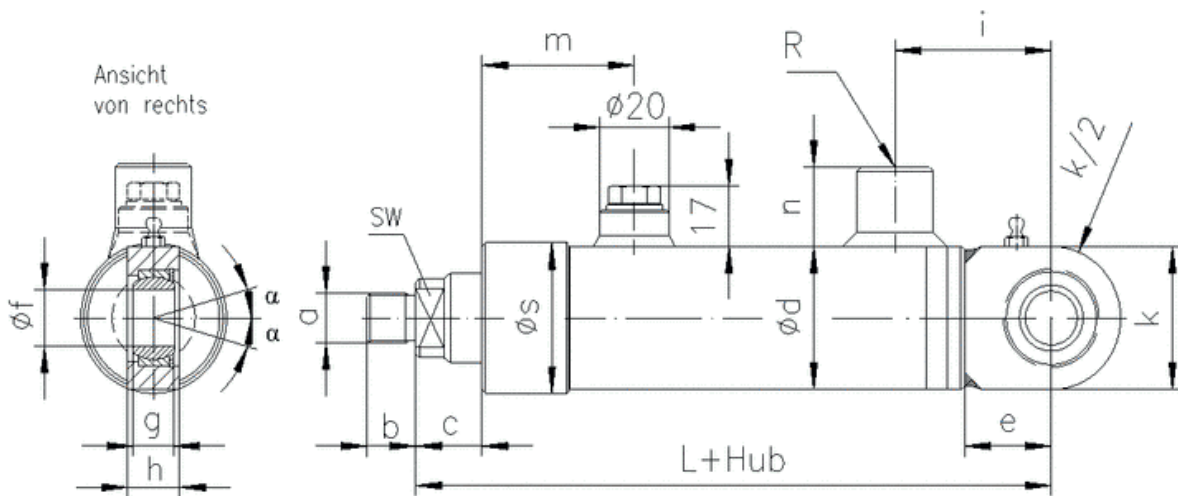

| Ø Stange   | L   | e  | c  | n  | Ød  | Øs  | m    | i   | k   | Øf | g  | h  | S<br>W | α<br>Grad | a        | b  | R      |
|------------|-----|----|----|----|-----|-----|------|-----|-----|----|----|----|--------|-----------|----------|----|--------|
| <b>20</b>  | 128 | 25 | 15 | 22 | 35  | 35  | 50   | 45  | 30  | 10 | 9  | 12 | 17     | 12        | M10x1,25 | 12 | R 1/4" |
| <b>25</b>  | 143 | 25 | 15 | 22 | 40  | 43  | 62   | 45  | 40  | 15 | 12 | 15 | 19     | 8         | M14x1,5  | 14 | R 1/4" |
| <b>30</b>  | 143 | 25 | 15 | 22 | 45  | 48  | 62   | 45  | 40  | 15 | 12 | 15 | 24     | 8         | M14x1,5  | 14 | R 3/8" |
| <b>35</b>  | 169 | 45 | 19 | 22 | 50  | 52  | 62   | 65  | 50  | 20 | 16 | 20 | 27     | 9         | M16x1,5  | 16 | R 3/8" |
| <b>40</b>  | 170 | 45 | 15 | 22 | 55  | 58  | 73   | 65  | 50  | 20 | 16 | 20 | 30     | 9         | M16x1,5  | 16 | R 3/8" |
| <b>50</b>  | 180 | 45 | 25 | 22 | 65  | 67  | 67   | 65  | 59  | 25 | 20 | 25 | 41     | 7         | M16x1,5  | 16 | R 3/8" |
| <b>60</b>  | 180 | 45 | 25 | 22 | 75  | 77  | 67   | 65  | 74  | 30 | 22 | 30 | 50     | 6         | M22x1,5  | 22 | R 3/8" |
| <b>70</b>  | 195 | 60 | 21 | 22 | 95  | 94  | 73,5 | 85  | 80  | 35 | 25 | 30 | 36     | 6         | M28x1,5  | 28 | R 3/8" |
| <b>80</b>  | 195 | 60 | 21 | 22 | 105 | 104 | 73,5 | 85  | 80  | 35 | 25 | 30 | 46     | 6         | M28x1,5  | 28 | R 3/8" |
| <b>90</b>  | 235 | 70 | 27 | 22 | 120 | 120 | 86,5 | 105 | 100 | 40 | 28 | 35 | 55     | 7         | M35x1,5  | 35 | R 1/2" |
| <b>100</b> | 245 | 70 | 27 | 22 | 135 | 134 | 88,5 | 107 | 100 | 40 | 28 | 35 | 60     | 7         | M35x1,5  | 35 | R 1/2" |