

Single-Action Hydraulic Cylinders for scissor lifts 250 bar

series: HZE3 > 500 mm Hub

Single-Action Hydraulic Cylinders for Scissor Lifts - 250 bar

Series: HZE3 > 500 mm Stroke

Position of the P6 and P7 vents and the P8 fitting

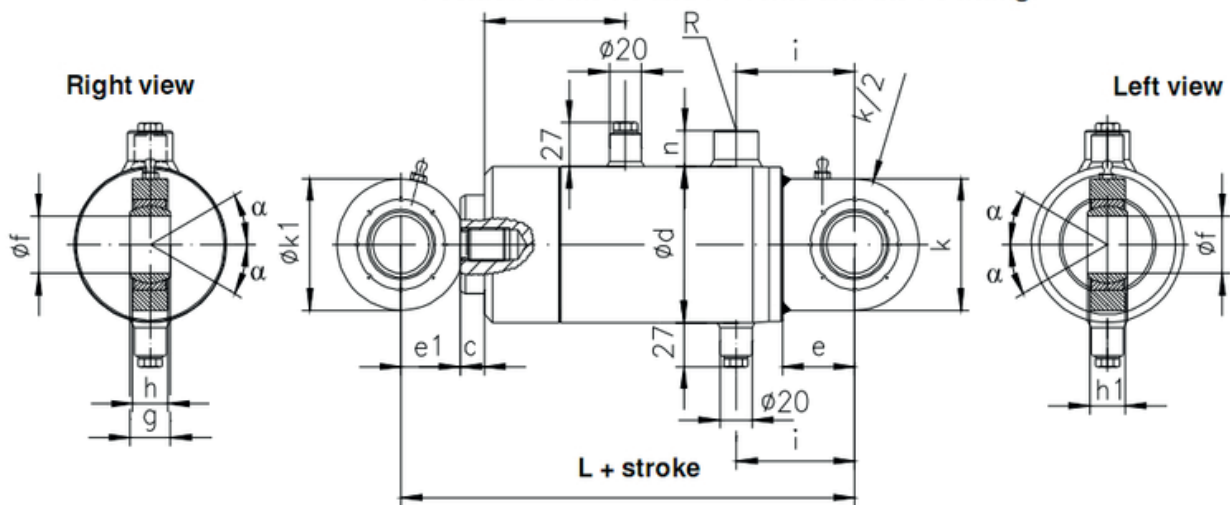

Rod ϕ	L	e1	c	n	ϕd	m	i	ϕf	k	h	g	ϕk_1	h_1	α deg.	R
50	287	37	12	22	85	162	74	35	80	22	25	80	22	6	R 3/8"
60	287	37	12	22	95	162	74	35	80	22	25	80	22	6	R 3/8"
70	315	40	12	22	110	182	79	40	90	24	28	90	25	7	R 3/8"
80	315	40	12	22	120	182	79	40	90	24	28	90	25	7	R 3/8"
90	355	47	10	22	135	207	86	50	106	30	35	106	31	6	R 3/8"
100	355	47	10	22	150	207	86	50	106	30	35	106	31	6	R 3/8"
110	385	55	8	22	168	212	105	60	124	38	44	124	38	6	R 1/2"
120	385	55	8	22	180	212	105	60	124	38	44	124	38	6	R 1/2"
130	399	62	10	22	203	212	115	70	140	42	49	140	42	6	R 1/2"

All dimensions in the table above apply for cylinders with a stroke length up to > 500 mm!